

# Phase One: Building Four

Building Size: ±142,500 SF

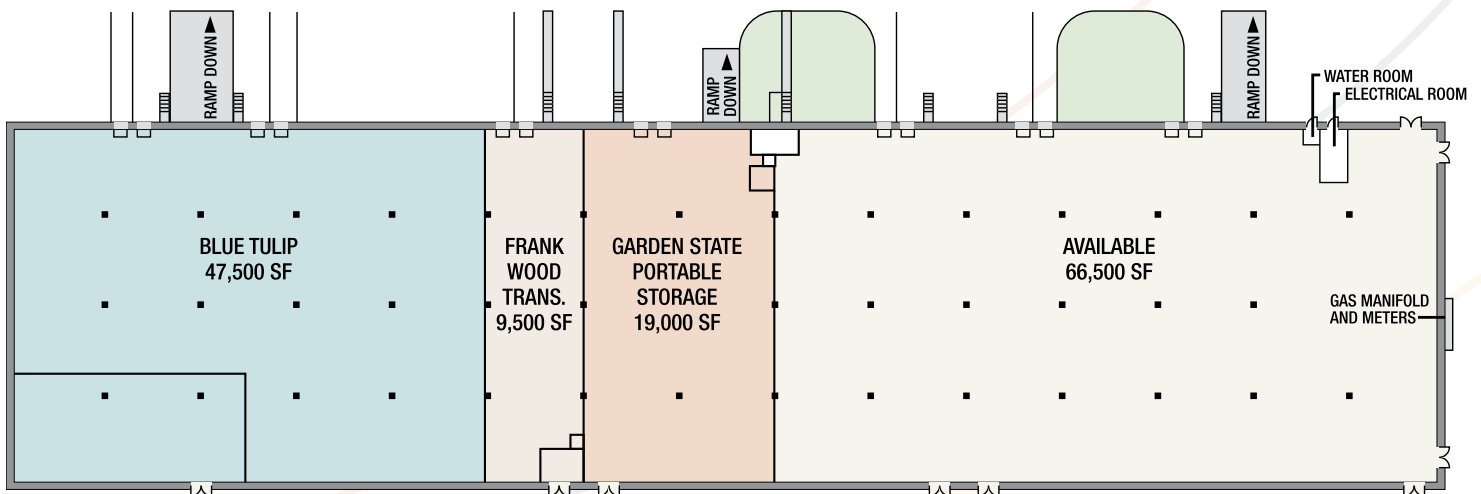

- Completed: 2005
- Building size: ±142,500 SF (divisible to ±9,500 SF)
- Office space: To suit
- Ceiling height: 28' clear
- Floor: 6" concrete slab
- Column spacing: 48' x '50 (60' at loading docks)
- Car Parking: 140
- Truck Docks: 14 (expandable) and three drive-in doors
- Sprinkler system: ESFR

A commission computed in accordance with the rates and conditions of our agency agreement with our principal, when received from our principal, will be paid to the cooperating broker who consummates a lease which is unconditionally executed and delivered by and between lessor and lessee. (Inquire for rates and additional conditions.) No warranty or representation, express or implied, is made as to the accuracy of the information contained herein, and same is submitted subject to errors omissions, change of price, rental or other conditions, withdrawal without notice, and to any specific listing conditions, imposed by our principals.